

**NOTE:**  
 KNEE WALL/FENCE TO BE INSTALLED  
 ALONG FOURAKER ROAD FRONTAGE.



CONNELLY & WICKER INC.  
 10060 SKINNER LAKE DR, STE. 500  
 JACKSONVILLE, FL 32246  
 PHONE: (904) 265-3030  
 FAX: (904) 265-3031  
 www.cwieng.com ~ C.A. Number: 3650

# FOURAKER SUBDIVISION

SITE PLAN REVISIONS  
 JUNE 20, 2017

JUSTIN WILLIAMS, P.E.  
 Reg. Engineer  
 PE NO. 69286

FOURAKER SUBDIVISION  
 PREPARED FOR  
 DUVAL COUNTY, FL  
 LAND ROVER PROPERTIES, LLC

EXHIBIT M-  
 FENCING MAP

No.	Date	Revision	By

Planning • Engineering • Landscape Architecture  
**OW** Connelly & Wicker Inc.  
 1000 Shores Lake Drive, Suite 500 Jacksonville, Florida 32246  
 (904) 265-3030 FAX: (904) 265-3031 www.cweng.com  
 C.A. Number: 3650 I.A. Number: LC26000311

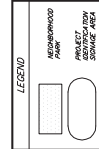
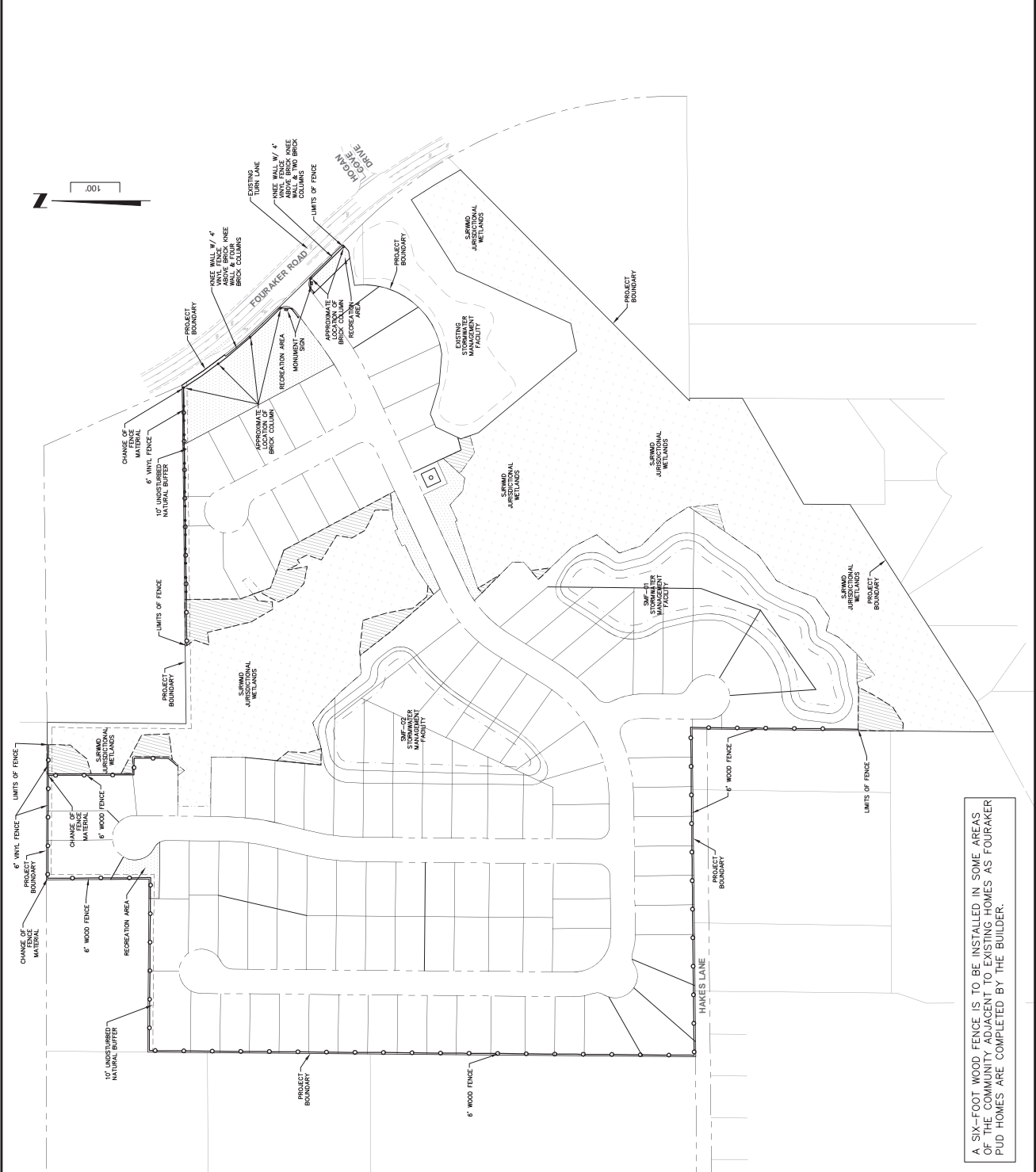

A SIX-FOOT WOOD FENCE IS TO BE INSTALLED IN SOME AREAS OF THE COMMUNITY AND IS DIFFERENT FROM EXISTING HOMES AS FOURAKER POD HOMES ARE COMPLETED BY THE BUILDER.

## PVC Embossed Tru-Grain



**Available in White (special order), Tan, Clay and Stone. Embossed design in Privacy and Ranch Rail. Rails, Pickets, u-channel, and posts are all embossed texture. Caps and accents are not embossed.**

